

1. PRODUCT NAME

American Architectural III Panels for wall applications.

2. MANUFACTURER

AMERICAN BUILDINGS COMPANY

1150 State Docks Road
Eufaula, Alabama 36027
Phone: (334) 687-2032

3. PRODUCT DESCRIPTION

These wall panels provide 36" width coverage with a decorative shadow line and semi-concealed fasteners. Rib height is 1 ¼" on 12" centers.

Basic Use: A wall panel system for new or retrofit construction.

Materials: Architectural III wall panels are available in 29, 26, 24 gage 80,000 psi or 22 gage 50,000 psi in either G90 zinc-coated (galvanized) steel or aluminum-zinc alloy-coated (AZ50 or AZ55) steel. Pre-painted Panels have American Buildings Company's SmartKote (Kynar 500®) or Silicone Modified Polyester Finish. An embossed finish is available as an option. Architectural III panels are attached to the secondary framing members by self-drilling carbon steel screws, No. 12 x 1 1/4" hex washer head, cadmium or zinc plated. Architectural III panel sidelaps are stitched with self-drilling carbon steel screws, No. 14 X 3/4" cadmium or zinc plated. Fasteners are normally color coordinated with a premium coating system that protects against corrosion and weathering.

Maximum insulation thickness allowed with these panels is 6".

4. TECHNICAL DATA

The Architectural III panel has been tested in accordance with Air Infiltration, ASTM E 283 and Water Penetration, ASTM E331. The Architectural III panel has also been Miami-Dade County approved. This panel has received a Class A fire rating when tested in accordance with test procedure ASTM E108.

5. INSTALLATION

Installation should be performed in accordance with American Buildings Company's manuals and building erection drawings, and should be by a qualified installer using proper tools and equipment. Systems are installed by American Buildings Company Authorized Builders.

6. AVAILABILITY

For availability, contact:

AMERICAN BUILDINGS COMPANY

7. WARRANTY

Thirty-five year material warranties are available.

8. MAINTENANCE

Only normal routine maintenance is required over the life of the panels.

9. TECHNICAL SERVICES

For information, contact:

AMERICAN BUILDINGS COMPANY

10. PRODUCT NOTES

American Buildings Company reserves the right to revise all standard specifications and information. American Buildings Company regularly updates its published "Standard Specifications" on the American Buildings web site, www.americanbuildings.com, which supercede and replace any previously published standard specifications of American Buildings Company.

....continued

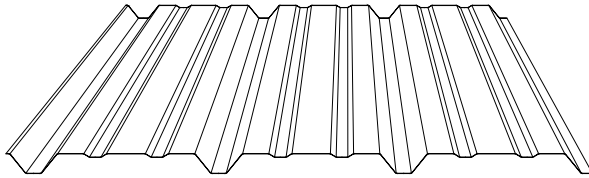

PANEL PROFILE

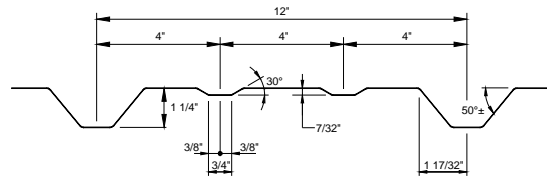

PARTIAL CROSS SECTION

Engineering Properties of American Buildings Company Architectural III Panel											
Designated Gage of Steel	Steel Yield KSI	Base Metal Thick. (In.)	Total Thick. (In.)	Panel Weight (lbs. / ft. ²)	Top In Compression			Bottom In Compression			Fb KSI
					Ix (In. ⁴ / ft.)	Sx (In. ³ / ft.)	Ma K-IN.	Ix (In. ⁴ / ft.)	Sx (In. ³ / ft.)	Ma K-IN.	
29 Ga.	80	0.0137	0.0153	0.75	0.027	0.036	1.30	0.030	0.025	0.90	36
26 Ga.	80	0.0177	0.0193	0.94	0.036	0.047	1.69	0.043	0.039	1.40	36
24 Ga.	80	0.0225	0.0241	1.17	0.048	0.060	2.16	0.060	0.054	1.94	36
22 Ga.	50	0.0300	0.0316	1.54	0.070	0.082	2.46	0.083	0.085	2.55	30

Gage of Panel	No. of Spans	Load Type	Maximum Total Uniform Load in PSF							
			Span Lengths, Ft.							
			3.00	3.50	4.00	4.50	5.00	6.00	7.00	7.33
29 Ga.	1	POS	57	49	43	38	28	16	10	9
		NEG	-63	-47	-36	-29	-23	-16	-11	-10
	2	POS	54	46	35	28	23	16	12	11
		NEG	-49	-42	-37	-33	-30	-23	-17	-16
	3	POS	61	53	43	35	28	20	15	14
		NEG	-56	-48	-42	-37	-34	-28	-21	-19
	4	POS	59	51	41	33	27	19	14	13
		NEG	-54	-46	-40	-36	-32	-26	-20	-18
26 Ga.	1	POS	103	89	69	52	38	22	14	12
		NEG	-100	-74	-57	-46	-37	-26	-16	-14
	2	POS	87	73	57	45	37	26	19	17
		NEG	-64	-55	-48	-42	-38	-31	-23	-21
	3	POS	99	85	70	56	46	32	24	21
		NEG	-72	-62	-54	-48	-43	-36	-28	-26
	4	POS	96	82	66	52	43	30	22	20
		NEG	-70	-60	-52	-46	-42	-35	-26	-24
24 Ga.	1	POS	156	115	89	69	50	29	18	16
		NEG	-141	-104	-80	-63	-51	-36	-23	-20
	2	POS	136	103	80	63	51	36	26	24
		NEG	-81	-69	-61	-54	-49	-40	-29	-27
	3	POS	155	128	99	78	64	44	33	30
		NEG	-92	-79	-69	-61	-55	-46	-36	-33
	4	POS	149	120	92	73	60	42	31	28
		NEG	-89	-76	-66	-59	-53	-44	-34	-31
22 Ga.	1	POS	179	132	102	80	65	42	27	23
		NEG	-186	-137	-105	-83	-68	-47	-32	-28
	2	POS	184	136	105	83	67	47	35	31
		NEG	-114	-98	-86	-76	-65	-45	-33	-30
	3	POS	220	169	130	103	84	58	43	39
		NEG	-130	-111	-98	-87	-78	-56	-42	-38
	4	POS	211	158	122	96	78	55	40	37
		NEG	-125	-107	-94	-83	-75	-53	-39	-35

- The panels were checked for bending, shear, combined bending and shear, deflection, web crippling and panel pullover. Deflection was limited to span/120
- Section Properties have been calculated in accordance with the 2001 *North American Specification for the Design of Cold-Formed Steel Structural Members*.
- Minimum yield strength of 29, 26 and 24 gage steel is 80,000 psi. Minimum yield strength of 22 gage steel is 50,000 psi.
- Steel panels are either aluminum-zinc alloy or G-90 coated. The base metal thickness was used in determining section properties.
- Positive load (POS) is applied inward toward the panel supports and is applied to the outer surface of the full panel cross-section. Negative load (NEG) is in the opposite direction.