

Index

[IN01/AA, Suggested Insulation Attachments at Eave](#)
[IN02/AA, Suggested Insulation Detail at Wall Panel Base](#)

Suggested Insulation Attachments at Eave

IN01/AA

SAFETY PRECAUTION:
WORKERS SHOULD BE TRAINED IN
THE PROPER ERECTION PROCEDURES
FOR ALL JOBS.

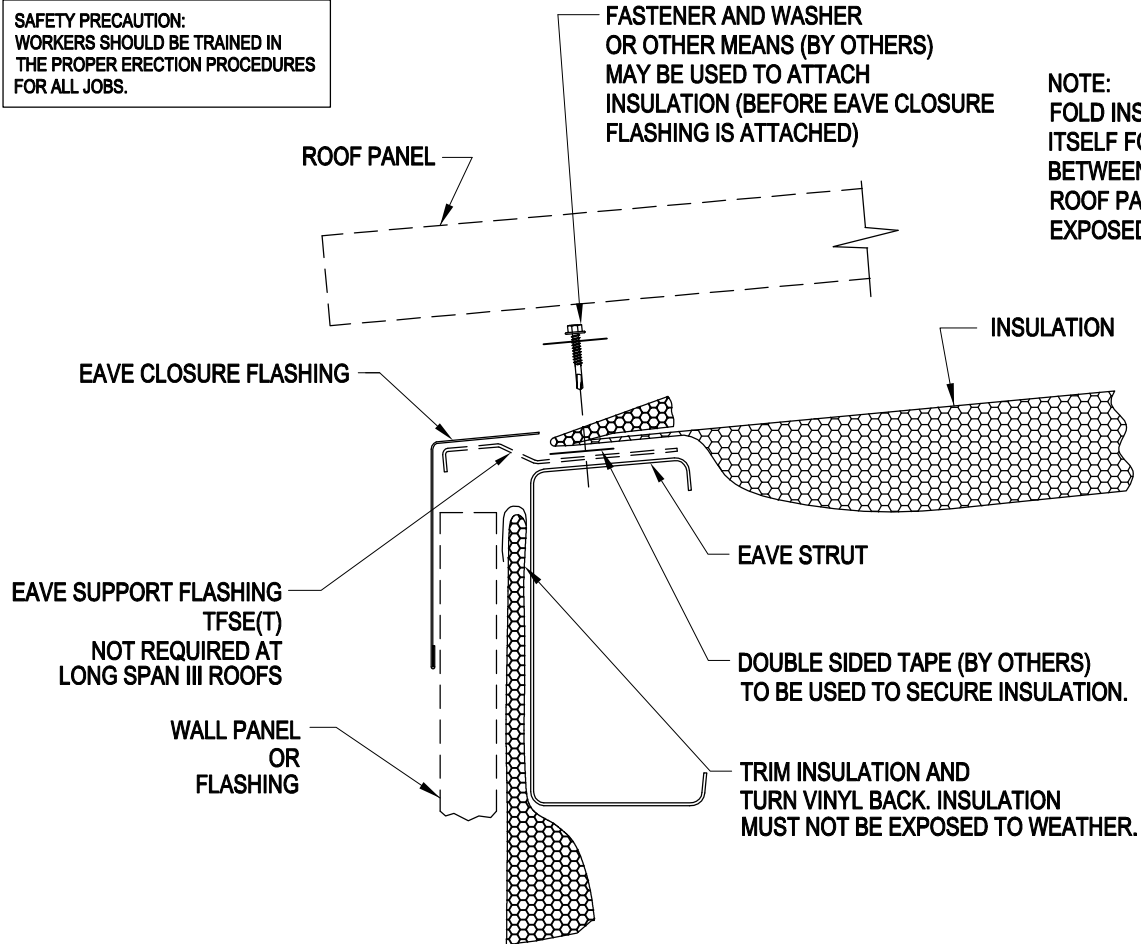

NOTE:
FOLD INSULATION BACK ONTO
ITSELF FOR COMPRESSION
BETWEEN EAVE STRUT AND
ROOF PANEL. IT MUST NOT BE
EXPOSED TO THE WEATHER.

SUGGESTED INSULATION ATTACHMENTS AT EAVE

IN01
AA

[Download the DWG file by clicking here.](#)

[To Section Index](#)

Suggested Insulation Detail at Wall Panel Base

IN02/AA

**SAFETY PRECAUTION:
WORKERS SHOULD BE TRAINED IN
THE PROPER ERECTION PROCEDURES
FOR ALL JOBS.**

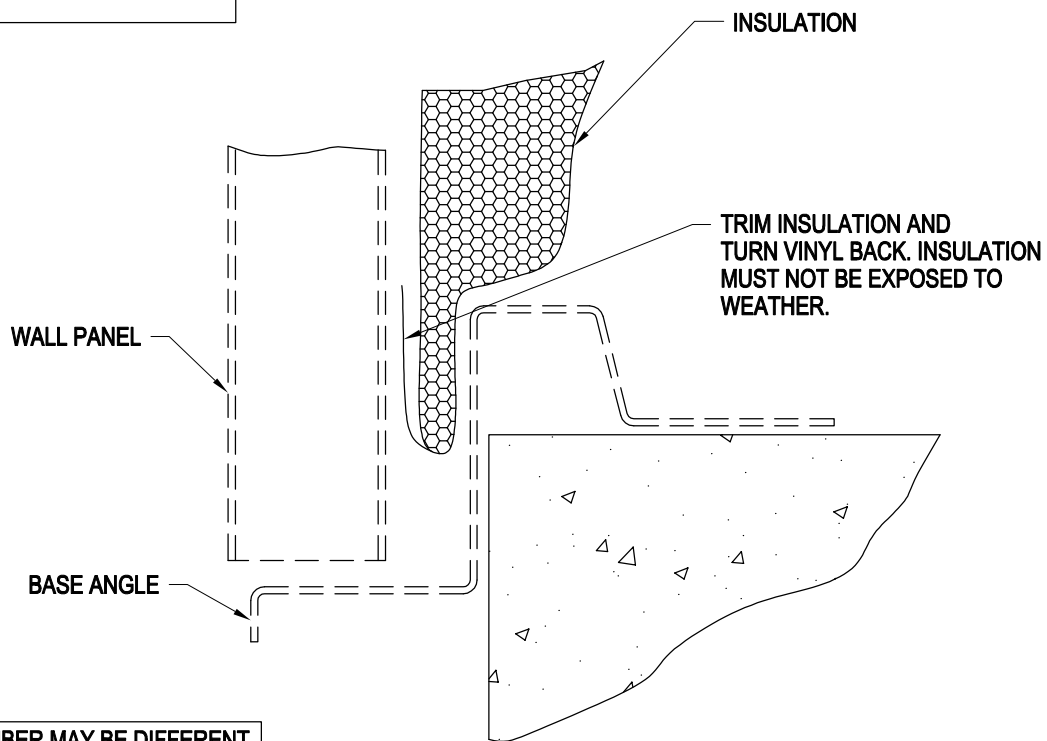

**NOTE: BASE MEMBER MAY BE DIFFERENT
FROM WHAT IS SHOWN.**

SUGGESTED INSULATION DETAIL AT WALL PANEL BASE

IN02
AA

[Download the DWG file by clicking here.](#)

[To Section Index](#)